

Connecting the Terminal Block

Connect main supply (brown - Live, blue - Neutral) into terminal block making sure all connections are tight.

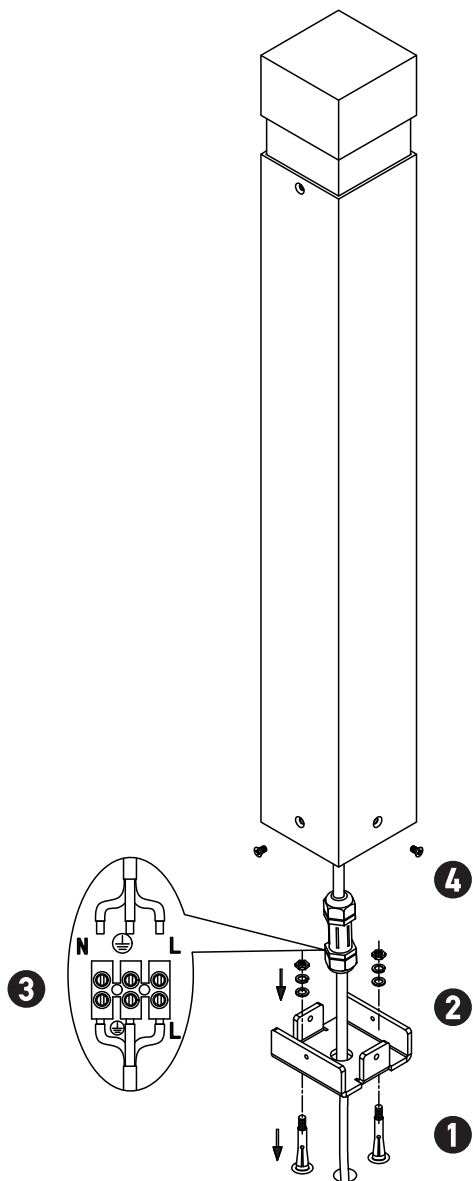
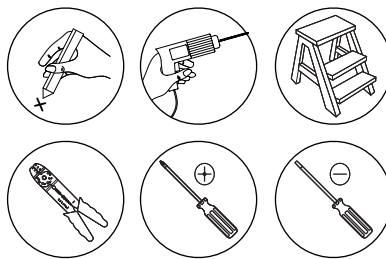

OUTDOOR BOLLARD LIGHT

E425

Please read instructions before commencing installation and retain for future reference.

SPECIFICATIONS

- **Lamp Type:** LED | 15W | 3000K | CRI 95 | Non Dimmable
- **Material:** Aluminium | PC Diffuser
- **Ingress Protection:** IP 65 Protection against entry of solid objects greater than 12mm in diameter.

INSTALLATION INSTRUCTIONS

! Electrical products can cause death, injury, or property damage. Maintenance and installation should only be carried out by a professional electrician.

- Turn off power at the main breaker.
- Drill holes and insert anchors in the mounting surface.
- Connect power wires to bollard wires using the provided connector (match live, neutral, ground).
- Tighten connector securely for waterproofing.
- Mount bollard light over anchors and fasten with screws.
- Check all connections and mounting stability.
- Turn power back on and test the light.

WARNING

! Make sure that the products are installed properly before connecting to electricity. Do not cover the luminaire. Do not exceed the maximum wattage rating of the lamp. If the light source is contained in this luminaire (integrated LED), it shall only be replaced by the manufacturer, his service agent, or a similarly qualified person.

