

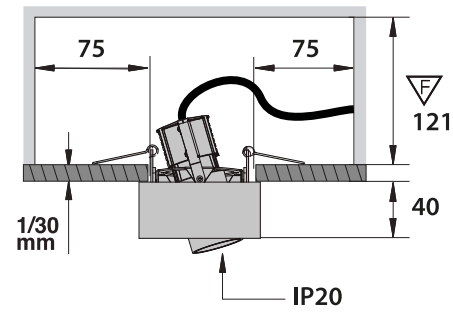

## SEMI-RECESSED 1L

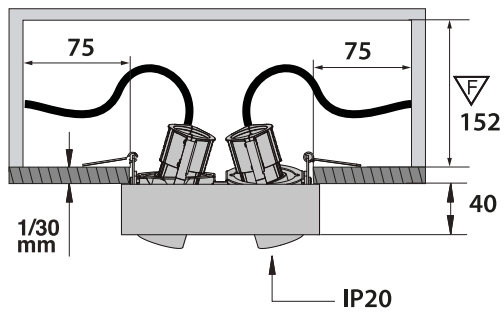

## SEMI-RECESSED 2L



## TRIM 1L

### A LUMINAIRE INSTALLATION

INSTALACIÓN DE LA LUMINARIA / INSTALLAZIONE DELLA LAMPADA /  
INSTALLATION DER BELEUCHTUNG / INSTALLATION DU LUMINAIRE /  
INSTALAÇÃO DO APARELHO DE ILUMINAÇÃO / 照明器具の設置・据付け /  
灯具的安裝 / МОНТАЖ ОСВЕТИТЕЛЬНОГО ПРИБОРА /  
ШАМДАЛДЫ ОРНАТУ / تركيب وحدة الإنارة

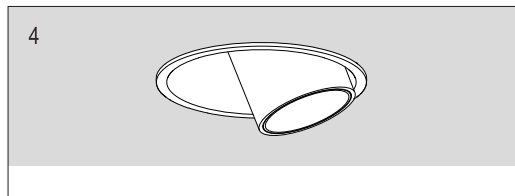
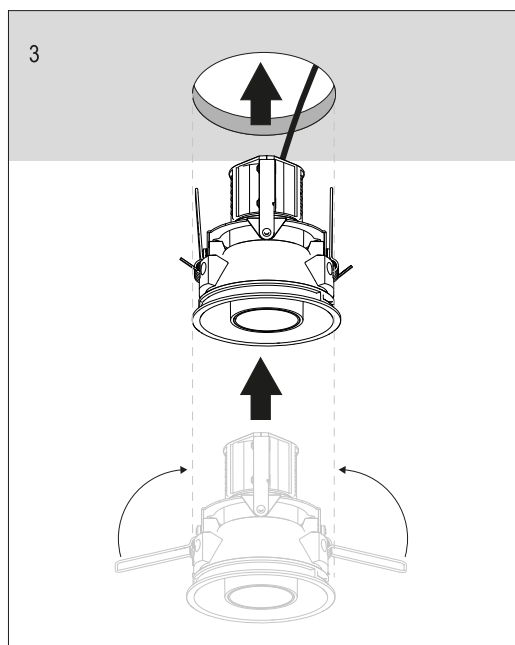
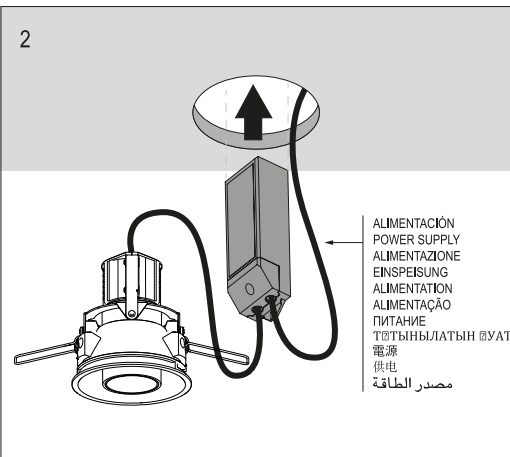
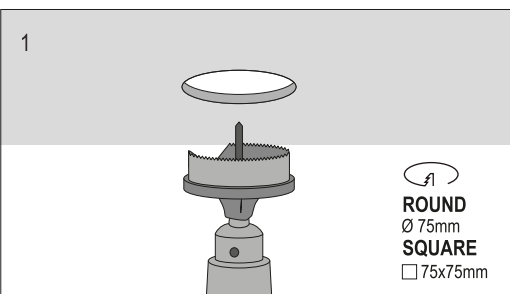

### A LUMINAIRE TILT ADJUSTMENT

REGULACIÓN DE LA INCLINACIÓN DE LA LUMINARIA / REGOLAZIONE  
DELL'INCLINAZIONE DEL DISPOSITIVO DI ILLUMINAZIONE /  
NEIGUNGSREGLER DER LICHTQUELLE / RÉGLAGE DE L'INCLINAISON  
DU LUMINAIRE / REGULAÇÃO DA INCLINAÇÃO DA LUMINARIA / 照明  
の角度調節 / 调节照明的倾斜度 / РЕГУЛИРОВКА НАКЛОНА  
ОСВЕТИТЕЛЬНОГО ПРИБОРА / ШАМДАЛДЫ БӨККЕЙТҮДІ РЕТТЕУ  
ضبط إمالة المصباح

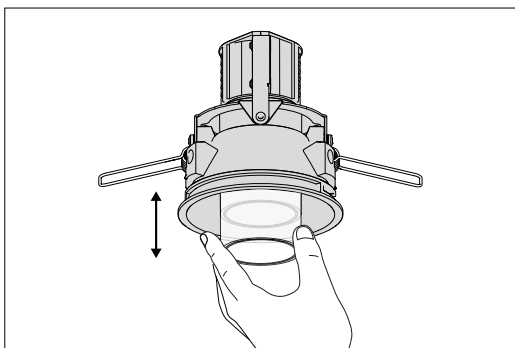
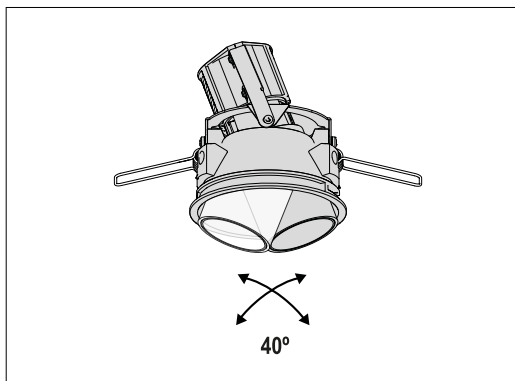

## TRIM 2L

### B LUMINAIRE INSTALLATION

INSTALACIÓN DE LA LUMINARIA / INSTALLAZIONE DELLA LAMPADA /  
INSTALLATION DER BELEUCHTUNG / INSTALLATION DU LUMINAIRE /  
INSTALAÇÃO DO APARELHO DE ILUMINAÇÃO / 照明器具の設置・据付け /  
灯具的安裝 / МОНТАЖ ОСВЕТИТЕЛЬНОГО ПРИБОРА /  
ШАМДАЛДЫ ОРНАТУ / تركيب وحدة الإنارة

## B.2 TRIM

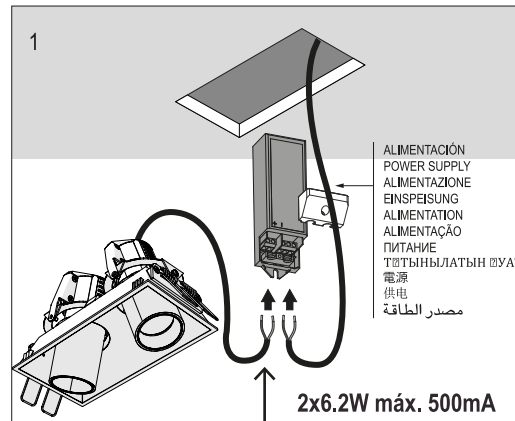
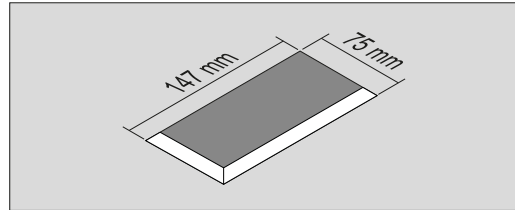

**!** Beware of correct polarity (±) Red + / Black -  
Cuidado con la polaridad correcta (±) Rojo +  
/ Negro -

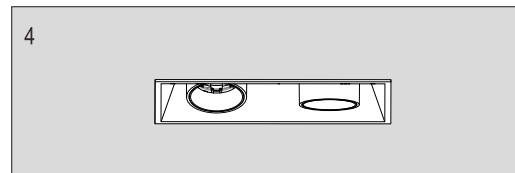
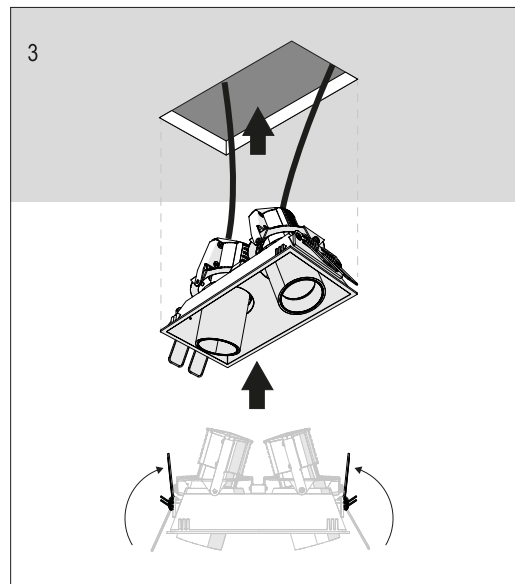
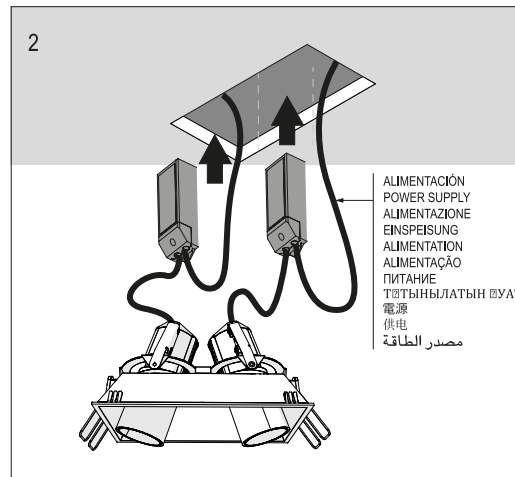

## SEMI-RECESSED

### C LUMINAIRE INSTALLATION

INSTALACIÓN DE LA LUMINARIA / INSTALLAZIONE DELLA LAMPADA /  
INSTALLATION DER BELEUCHTUNG / INSTALLATION DU LUMINAIRE /  
INSTALAÇÃO DO APARELHO DE ILUMINAÇÃO / 照明器具の設置・据付け /  
灯具的安裝 / МОНТАЖ ОСВЕТИТЕЛЬНОГО ПРИБОРА /  
ШАМДАЛДЫ ОРНАТУ / تركيب وحدة الإنارة

### C.1 1 AND 2 LIGHTS

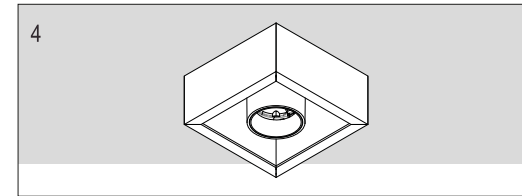
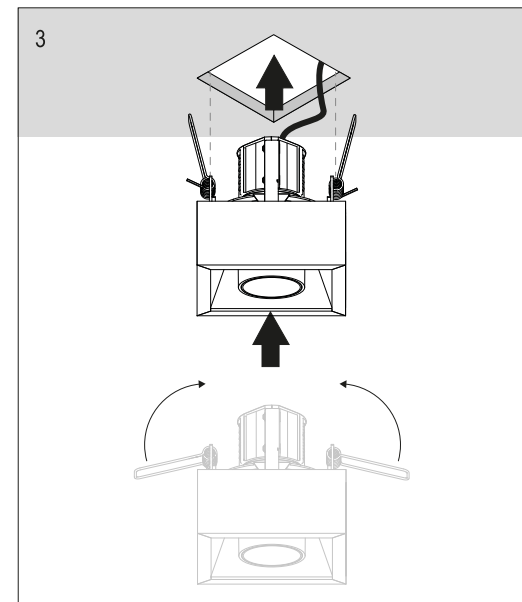
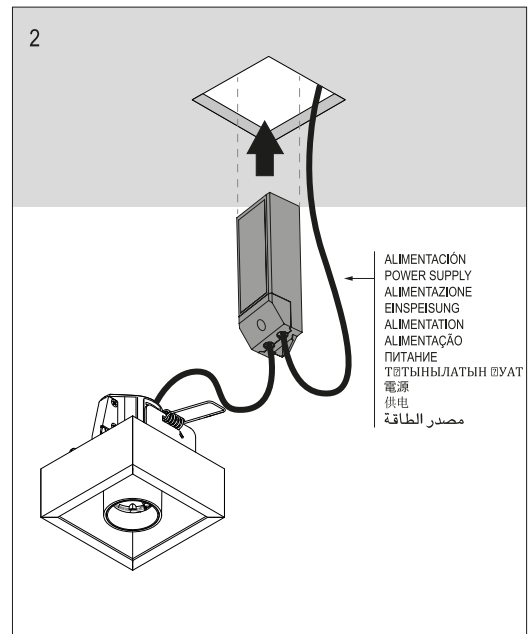
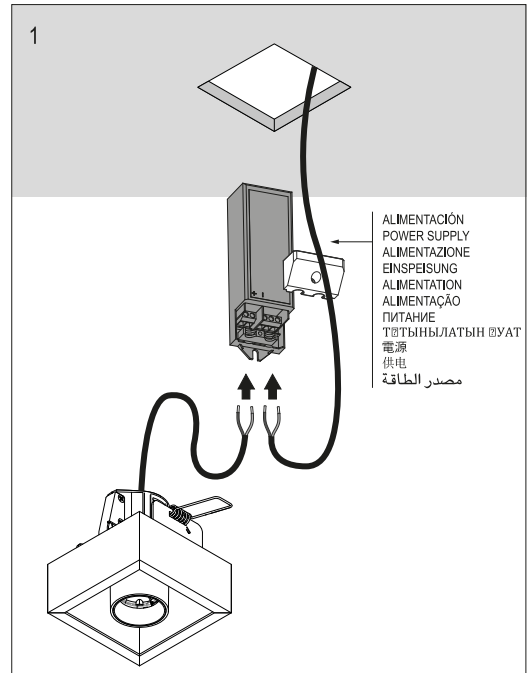
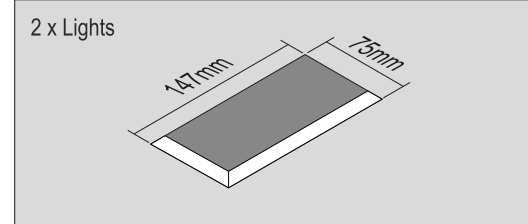
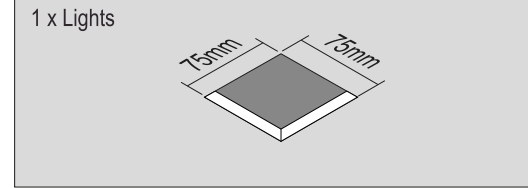

## ACCESSORIES

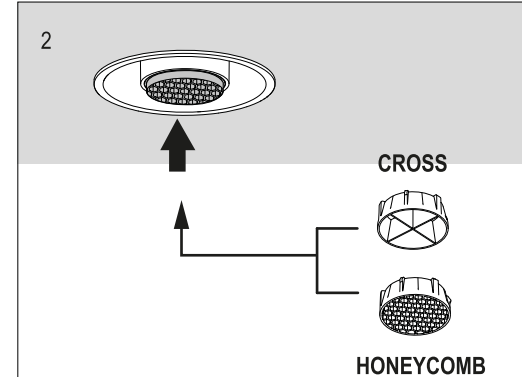
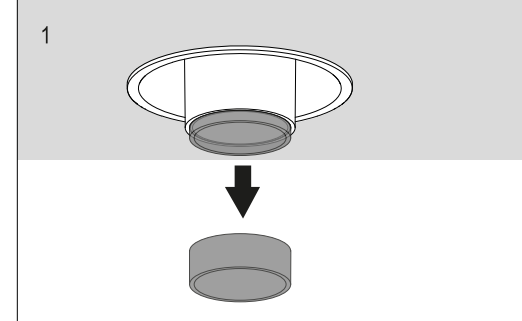

**!** MAX 1 Accessory / 1 Accesorio

For Johnny 80 with accesories the output  
driver current must be 450mA MAX.  
Para Johnny 80 con accesorios, la corriente  
del controlador de salida debe ser 450mA  
MAX.

